

- ✓ Added wand and holder
- ✓ Solid construction
- ✓ Height-adjustable
- ✓ Quality high pressure swivel



TECHNICAL DATA

Pressure 4000 psi
Temperature 250°F
Inlet 3/8" NPTF



FL-PH 750

FEATURES

Two Tools In One

The wand quick connects to the existing HP-gun allowing you to prep your surface, clean corners, rinse over spray and clean other hard to reach areas.



Adjustable Height (FL-PH Series)

Stainless steel frame for added stability. Adjust to compensate for uneven surfaces.



Stainless Steel Caster (Premium Quality)

Four 4" stainless steel casters with custom mounting brackets ensure easy manoeuvring even in confined spaces.
 Part No. 80.956

Rotor Arms

Can withstand up to 4000 psi, are precision welded and balanced.



2cw2 (2 Arms / 2 Nozzles)

Part No. 82.942 (ø 18.5")

3cw3 (3 Arms / 3 Nozzles)

Part No. 82.943 (ø 27.5")

Optional: Part No. 82.9069 (ø 17.7"), 1/8"

Swiss Engineering

High rpm stainless steel swivel features reinforced self lubricated stainless steel ball bearings for improved performance. The dual spring based carbide seal system, guarantees long lasting operation under tough conditions.



Part No. 55.253

Name	Part No.	ø	Weight	Swivel	Rotor Arm	Wand Nozzle	HP- Nozzles	HP- Gun	Stainless Steel Caster
FL-PH 520	80.774	21"	35.7 lbs	1x DYCI	2x 1/8" NPTF	1x 1506	2x 1503	1x	4x ø 4"
FL-PH 750	80.775	30"	49.6 lbs		3x 1/8" NPTF	1x 1508	3x 1503		

CONTRACTOR „BIG“ FEATURES

Large caster (FL-PB Series)

The quality stainless steel caster and the two pneumatic tires enables easy maneuvering over uneven surfaces like ramps, grates and textured surfaces.

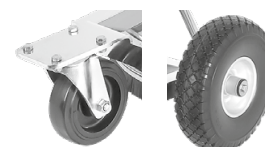

FL-PH 520

FL-PB 520

Name	Part No.	ø	Weight	Swivel	Rotor Arm	Wand Nozzle	HP- Nozzles	HP- Gun	Caster
FL-PB 520	80.679	21"	49.6 lbs	1x	2x 1/8" NPTF	1x 1506	2x 1503	1x	1x ø 5"
FL-PB 750	80.689	30"	58.4 lbs	DYCI	3x 1/8" NPTF	1x 1508	3x 1503		2x ø 10"