

- ✓ Added lance and holder
- ✓ Solid construction
- ✓ Height-adjustable
- ✓ Quality high pressure swivel



TECHNICAL DATA

Pressure 275 bar
Temperature 120°C
Inlet G3/8" F



FL-PH 750

FEATURES

Two Tools In One

The lance quick connects to the existing HP-gun allowing you to prep your surface, clean corners, rinse over spray and clean other hard to reach areas.



Adjustable Height (FL-PH Series)

Stainless steel frame for added stability. Adjust to compensate for uneven surfaces.



Stainless Steel Caster (Premium Quality)

Four 100mm stainless steel casters with custom mounting brackets ensure easy manoeuvring even in confined spaces.

Part No. 80.956

Rotor Arms

Can withstand up to 275 bar, are precision welded and balanced.



2cw2 (2 Arms / 2 Nozzles) **3cw3** (3 Arms / 3 Nozzles)

Part No. 82.942 (ø 470mm) Part No. 82.943 (ø 700mm)

Optional: Part No. 82.9069 (ø 450mm), 1/8"

Swiss Engineering

High rpm stainless steel swivel features reinforced self lubricated stainless steel ball bearings for improved performance. The dual spring based carbide seal system, guarantees long lasting operation under tough conditions.



Part No. 55.253

Name	Part No.	ø	Weight	Swivel	Rotor Arm	Lance Nozzle	HP- Nozzles	HP- Gun	Stainless Steel Caster
FL-PH 520	80.754	520	16.2kg	1x DYCI	2x 1/8" NPTF	1x 1506	2x 1503	1x	4x ø 100
FL-PH 750	80.755	750	22.5kg		3x 1/8" NPTF	1x 1508	3x 1503		

CONTRACTOR „BIG“ FEATURES

Large caster (FL-PB Series)

The quality stainless steel caster and the two pneumatic tires enables easy maneuvering over uneven surfaces like ramps, grates and textured surfaces.

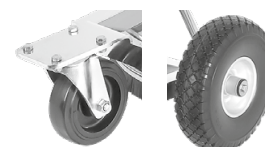

FL-PH 520

FL-PB 520

Name	Part No.	ø	Weight	Swivel	Rotor Arm	Lance Nozzle	HP- Nozzles	HP- Gun	Caster
FL-PB 520	80.675	520	22.5kg	1x DYCI	2x 1/8" NPTF	1x 1506	2x 1503	1x	1x ø 125 2x ø 260
FL-PB 750	80.685	750	26.5kg		3x 1/8" NPTF	1x 1508			